

## RECOMMENDATIONS AND REGULATIONS FOR VISITORS

The size of Museo Picasso Málaga allows you to enjoy an unhurried visit, one that will bring you a wealth of sensations. Therefore, we recommend that you take your time and enjoy every artwork in our collection, looking closely at everything we have on offer here. Immerse yourself in all the interesting details.

### Agenda

Exhibitions, educational activities, concerts and lectures: MPM offers a broad artistic and cultural programme. Find out what is scheduled for the day of your visit: [see agenda](#)

### Busiest times

MPM tends to have the most visitors from 11am to 2.30pm, and from 4pm to 5.30pm. Do bear this in mind if you want to avoid the queues.

### Warm clothes

The exhibition rooms are kept at a temperature of between 20°C and 22°C in order to conserve the works of art. This means that in spring and summer there is a difference in temperature between the outside and the inside of MPM and it is advisable to bring something warm to put on during your visit.

### Accessibility

- MPM has a specially designed activities programme for people with a variety of disabilities. Click [here](#) to see the programme.
- MPM has wheelchair access. To use it, please alert the staff on duty at the main entrance or ring the bell at the wheelchair access point. Members of MPM staff will assist you to enter the museum.

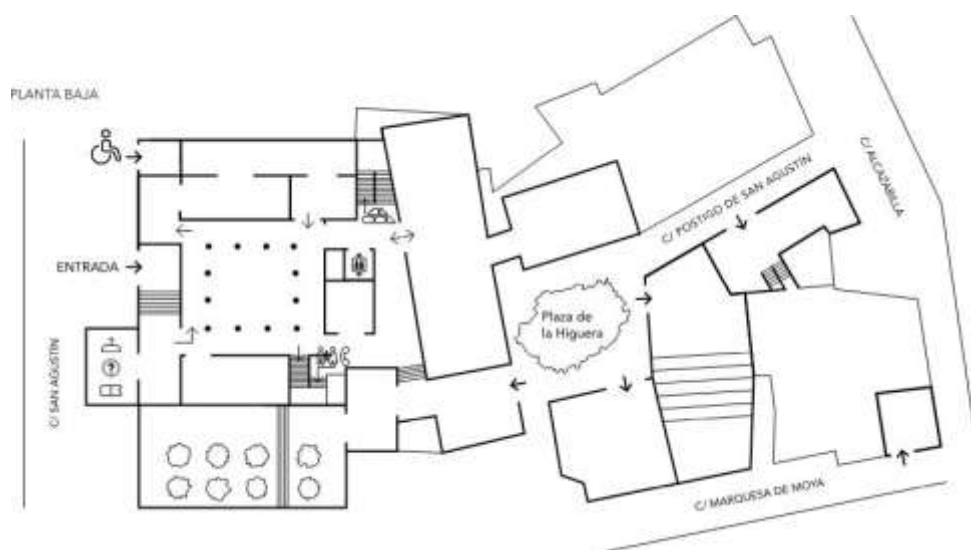

### **Cloakroom**

- The cloakroom service at MPM is free.
- For safety reasons access to MPM with backpacks, bags or umbrellas over the size of 32cm x 39cm, or with any other object which may put the works of art at risk, is prohibited. These objects must be left in the cloakroom.
- Objects which cannot be put through the scanner due to their size, such as suitcases or pushchairs, will not be accepted in the cloakroom. Objects which may be harmful to health cannot be accepted either.
- MPM provides free use of baby carriers, pushchairs and wheelchairs for visitors.

### **Regulations for visitors to MPM**

Visitors may not:

- Smoke inside MPM.
- Take photos or make videos inside the exhibition rooms or in other unauthorised areas.
- Bring animals into the building, except guide dogs.
- Enter MPM in bathing suits.
- Use mobile telephones inside the exhibition rooms.
- Consume food or drink outside of the MPM Café area.
- Touch the works of art.